



Satisfy Professional's Needs

Table Saw MLT100 255mm (10")

Wide cutting on the solid body

Left extension table with smooth sliding action

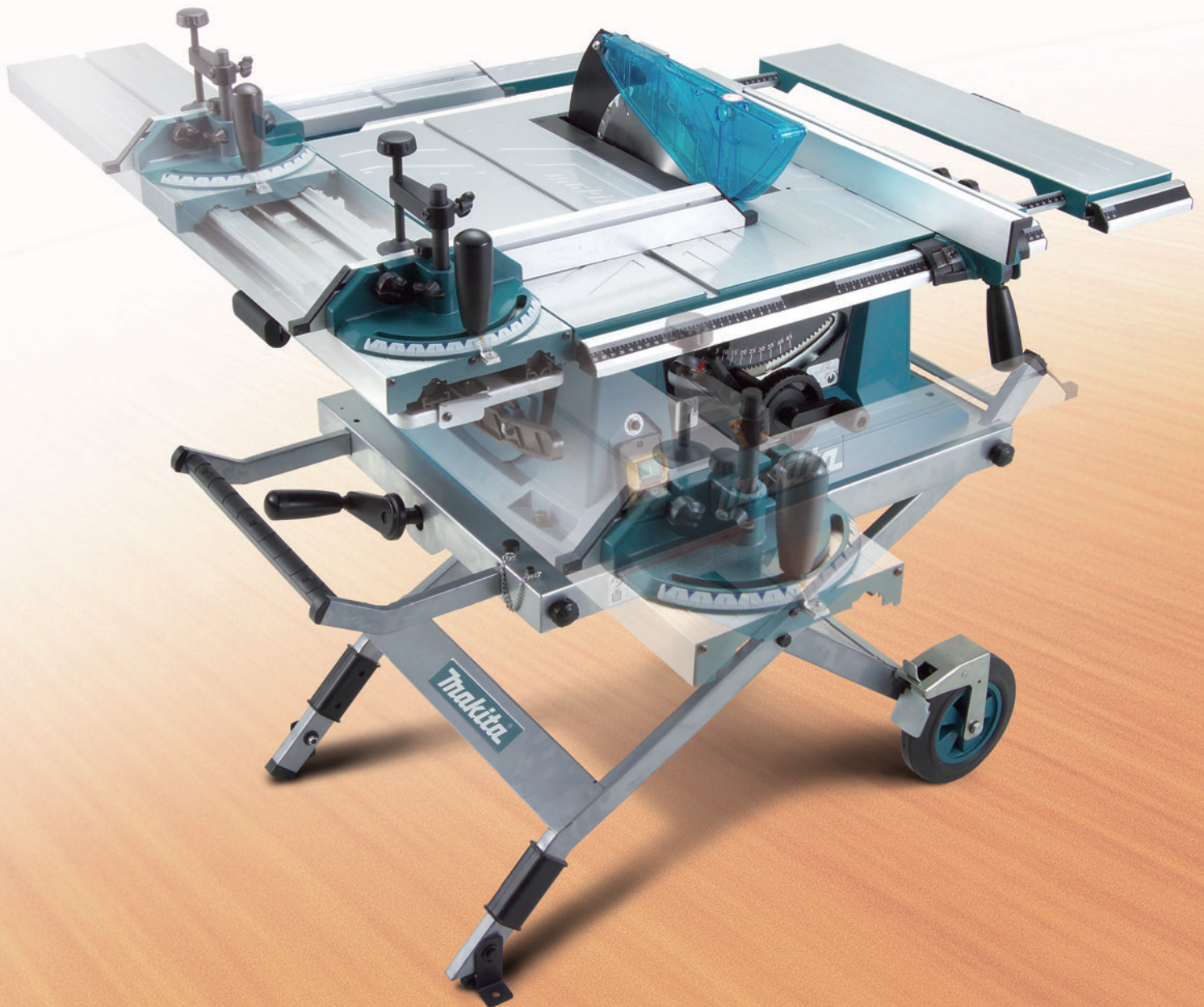

Stand Set is optional

Smooth cross cutting of large workpieces



Powerful
1,500 W

Left extension table with smooth sliding action

Miter gauge with vise
Miter angle: -60 -60



Rear and right extension tables

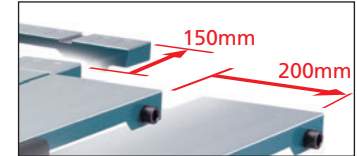

0-45
Bevel cut

Rip fence



Easy-to-read scale



Mounting the taller fence of L-shaped fence on the table allows operator to bevel-cut small workpieces.

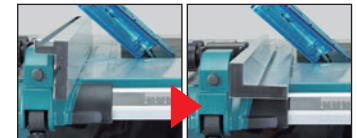

With electric brake

On-tool storage

holds commonly used accessories including: TCT Saw blade, Rip fence, Miter gauge, etc.



Storage hooks for power supply cord

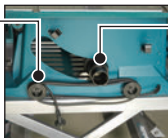

Connectable to Makita vacuum cleaners without adapter

Stand set Model WST03 (Optional wheeled stand) Part No. JM27000300

Net weight: 24kg
Dimensions (L x W x H):
in use:
1,015 x 590 x 560mm
in storage:
1,050 x 590 x 310mm



Height is adjustable from 310 to 560mm by turning a handle.

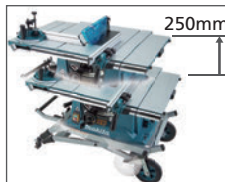

Two wheeled legs for easy mobility with the table saw mounted



Table Saw

- Double Insulation
- Soft Start
- Electric Brake
- Dust Collecting



MLT100 255mm (10")

JM27000295

Continuous rating Input Capacity	1,500W at 0 degrees : 91mm (3-9/16") at 45 degrees : 63mm (2-1/2")
Blade diameter	255mm (10")
No load speed (rpm)	4,300
Dimensions (L x W x H)	726 x 984 x 333mm (28-1/2" x 38-3/4" x 13-1/8")
Net weight	35kg (77lbs)
Power supply cord	2.5m (8.2ft)

Standard Equipment

TCT. Saw Blade, Rip Fence, Miter Gauge, Wrenches, Push Stick, Triangular Rule

Items of standard equipment and specifications may differ by country or area.

Makita Corporation

3-11-8 Sumiyoshi-cho, Anjo, Aichi, 446-8502 Japan

PRINTED IN JAPAN Z23412-2 AI-BA